

## S Type High Performance Chamfer End Mill - 3 Flutes S 型 90° 高效倒角銑刀 - 3 刃

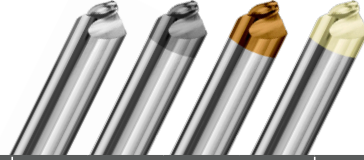

MODE	Diameter	A Angle	dc	Shank Diameter	Full Length	Flute	Coating				List Price
型號	d 刃徑	A 角度		D 柄徑	全長	Z 刃數		AlTiBN	TiSiN	ZrN-A	最低售價
SSM0603-90	6	90°	0.9	6	50	3	.00	.01	.02	.03	290
SSM0803-90	8		1.2	8	60	3	.00	.01	.02	.03	560
SSM1003-90	10		1.5	10	75	3	.00	.01	.02	.03	780
SSM1203-90	12		1.8	12	75	3	.00	.01	.02	.03	980

## S Type High Performance Chamfer End Mill - 5 Flutes S 型 90° 高效倒角銑刀 - 5 刃

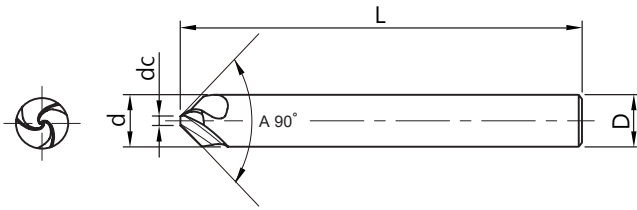
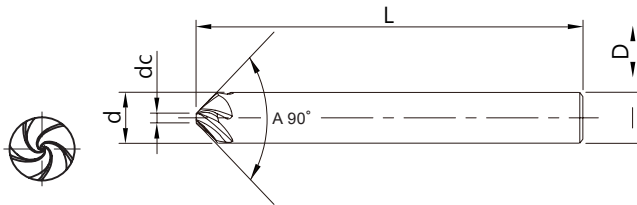

MODE	Diameter	A Angle	dc	Shank Diameter	Full Length	Flute	Coating			List Price
型號	d 刃徑	A 角度		D 柄徑	全長	Z 刃數	AlTiBN	TiSiN	ZrN-A	最低售價
SSM0605-90	6	90°	1.5	6	50	5	.01	.02	.03	300
SSM0805-90	8		2	8	60	5	.01	.02	.03	600
SSM1005-90	10		2.5	10	75	5	.01	.02	.03	820
SSM1205-90	12		3	12	75	5	.01	.02	.03	1100

Application 適用材質：

★ Perfect 最推薦

◎ Excellent 適合

○ Good 佳

Coating 塗層	Carbon steel, Alloy steel 炭素鋼, 合金鋼	Pre-harden steel 預硬鋼	High-hardened 高硬度鋼					Stainless steel 不鏽鋼	Titanium alloy 鈦合金	Nickel/Inconel alloy 鎳基合金	Copper alloy 銅合金, 銅	Aluminum alloy 鋁合金
		~45HRC	~50HRC	~55HRC	~60HRC	~65HRC						
											◎	◎
AlTiBN	◎	◎	○	○			○					
SI	○	○	○	◎								
ZrN-A	◎	◎	○	○			◎	○				

**SSM/SCDM Chamfer End Mill**  
**SSM/SCDM 倒角銑刀**

TSAE/TAE

產品規格表 **P30**

Specification page

SCDM

產品規格表 **P31-32**

Specification page

WORK MATERIAL 被切削材	MILD STEELS, CARBON STEELS, CAST IRON SS400、S55C、FC250 (~750N/mm <sup>2</sup> ) 一般構造用鋼、碳素鋼、鑄鐵		ALLOY STEELS, TOOL STEELS SCM、SKT、SKS、SKD (~30HRC) 合金鋼、工具鋼		HARDENED STEELS, PREHARDENED STEELS SKT、SKD、NAK55、HPM1 (30~38HRC) 調質鋼、預硬鋼		STAINLESS STEELS, HARDENED STEELS SUS304、SKD (38~45HRC)不鏽鋼、調質鋼		HARDENED STEELS, TITANIUM ALLOY STEELS (45~55HRC) 調質鋼、鈦合金		MAGNALIUM ALLOY, TITANIUM, TITANIUM ALLOY 鋁鎂合金、鈦及鈦合金	
MILL DIA. (mm) 直徑	SPEED (min <sup>-1</sup> ) 迴轉速	FEED (mm/min) 進給速	SPEED (min <sup>-1</sup> ) 迴轉速	FEED (mm/min) 進給速	SPEED (min <sup>-1</sup> ) 迴轉速	FEED (mm/min) 進給速	SPEED (min <sup>-1</sup> ) 迴轉速	FEED (mm/min) 進給速	SPEED (min <sup>-1</sup> ) 迴轉速	FEED (mm/min) 進給速	SPEED (min <sup>-1</sup> ) 迴轉速	FEED (mm/min) 進給速
Cutting Type 切削條件	Chamfer 倒角	Hole Chamfer/ Centering 孔倒角/ 定點	Chamfer 倒角	Hole Chamfer/ Centering 孔倒角/ 定點	Chamfer 倒角	Hole Chamfer/ Centering 孔倒角/ 定點	Chamfer 倒角	Hole Chamfer/ Centering 孔倒角/ 定點	Chamfer 倒角	Hole Chamfer/ Centering 孔倒角/ 定點	Chamfer 倒角	Hole Chamfer/ Centering 孔倒角/ 定點
Vc	80-140	40-70	60-100	30-50	30-80	15-40	20-50	10-25	15-40	7.5-20	120-200	60-100
Diameter 直徑(mm)	fz (mm/z)	fz (mm/rev)	fz (mm/z)	fz (mm/rev)	fz (mm/z)	fz (mm/rev)	fz (mm/z)	fz (mm/rev)	fz (mm/z)	fz (mm/rev)	fz (mm/z)	fz (mm/rev)
6	0.05	0.075	0.045	0.0675	0.045	0.0675	0.035	0.0525	0.03	0.045	0.07	0.105
8	0.06	0.09	0.055	0.0825	0.055	0.0825	0.04	0.06	0.035	0.0525	0.08	0.12
10	0.07	0.105	0.065	0.0975	0.065	0.0975	0.045	0.0675	0.04	0.06	0.09	0.135
12	0.08	0.12	0.075	0.1125	0.075	0.1125	0.05	0.075	0.045	0.0675	0.1	0.15
DEPTH OF CUT 加工深度	