

TM - Thread Mill.ISO 2D ISO 螺紋銑刀

ZrN-A nACRo

切削條件表 **P171**
Cutting Condition

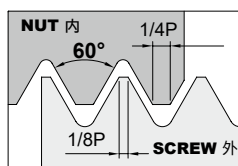

ISO R262 (DIN13) / 6H

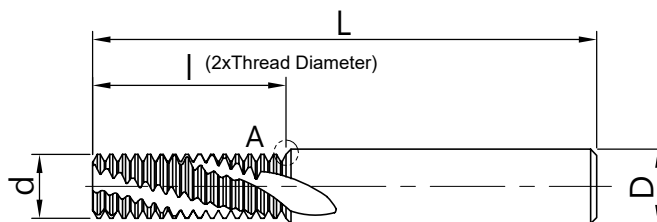

A部放大圖



MODE	Thread Diameter	Pitch	Diameter	Thread Length	Full Length	Shank Diameter	No. of flutes	Coating	
型號	M 螺紋	mm 螺距	d 刃徑	l 螺紋長度	L 全長	D 柄徑	z 刃數	ZrN-A	nACRo
TM-M0305002303	M3	0.5	2.3	6.75	50	4	3	.03	.08
TM-M0407003103	M4	0.7	3.1	8.75	50	4	3	.03	.08
TM-M0508003803	M5	0.8	3.8	10.80	50	4	3	.03	.08
TM-M0610004503	M6	1	4.5	13.50	65	6	3	.03	.08
TM-M0812506004	M8	1.25	6	18.13	65	6	4	.03	.08
TM-M1015007504	M10	1.5	7.5	21.75	80	8	4	.03	.08
TM-M1217509504	M12	1.75	9.5	27.13	80	10	4	.03	.08
TM-M1420010004	M14	2	10	31.00	80	10	4	.03	.08
TM-M1620012005	M16	2	12	35.00	105	12	5	.03	.08
TM-M2025016005	M20	2.5	16	43.75	105	16	5	.03	.08
TM-M2430016005	M24	3	16	52.50	110	16	5	.03	.08

TMC - Thread Mill.ISO. 2D Coolant ISO 螺紋銑刀/內冷

ZrN-A nACRo

切削條件表 **P171**
Cutting Condition

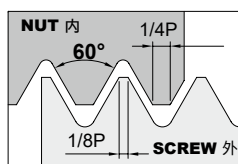

ISO R262 (DIN13) / 6H

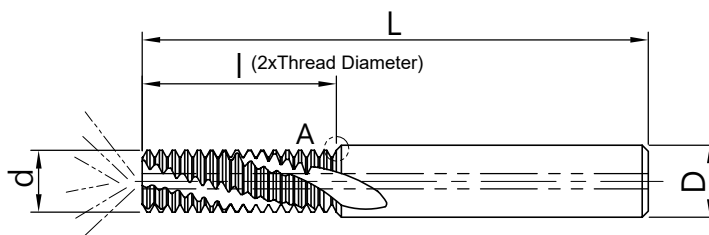

A部放大圖



MODE	Thread Diameter	Pitch	Diameter	Thread Length	Full Length	Shank Diameter	No. of flutes	Coating	
型號	M 螺紋	mm 螺距	d 刃徑	l 螺紋長度	L 全長	D 柄徑	z 刃數	ZrN-A	nACRo
TMC-M0610004503	M6	1	4.5	13.50	65	6	3	.03	.08
TMC-M0812506004	M8	1.25	6	18.13	65	6	4	.03	.08
TMC-M1015007504	M10	1.5	7.5	21.75	80	8	4	.03	.08
TMC-M1217509504	M12	1.75	9.5	27.13	80	10	4	.03	.08
TMC-M1420010004	M14	2	10	31.00	80	10	4	.03	.08
TMC-M1620012005	M16	2	12	35.00	105	12	5	.03	.08
TMC-M2025016005	M20	2.5	16	43.75	105	16	5	.03	.08
TMC-M2430016005	M24	3	16	52.50	110	16	5	.03	.08

TMEL - Thread Mill.ISO.1.5D ISO 螺紋銑刀/有效

ZrN-A nACRo

切削條件表 **P171**
Cutting Condition

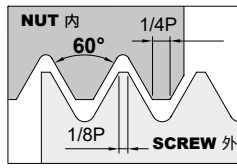

ISO R262 (DIN13) /6H

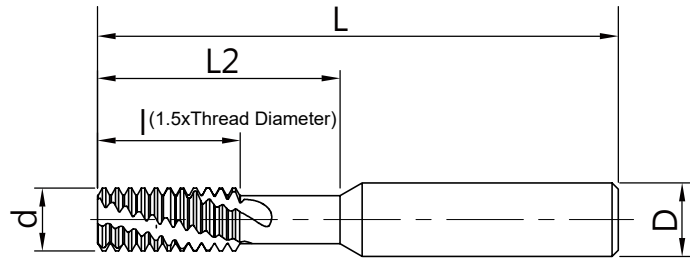

MODE	Thread Diameter	Pitch	Diameter	Thread Length	Full Length	Shank Diameter	No. of flutes	Effective Length	Coating	
型號	M 螺紋	mm 螺距	d 刃徑	l 螺紋長度	L 全長	D 柄徑	z 刃數	L2 有效長度	ZrN-A	nACRo
TMEL-M0305002303	M3	0.5	2.3	5.0	50	4	3	9.0	.03	.08
TMEL-M0407003103	M4	0.7	3.1	7.0	50	4	3	12.0	.03	.08
TMEL-M0508003803	M5	0.8	3.8	8.0	50	4	3	15.0	.03	.08
TMEL-M0610004503	M6	1	4.5	10.0	65	6	3	18.0	.03	.08
TMEL-M0812506004	M8	1.25	6	13.8	65	6	4	24.0	.03	.08
TMEL-M1015007504	M10	1.5	7.5	16.5	80	8	4	30.0	.03	.08
TMEL-M1217509504	M12	1.75	9.5	19.3	105	10	4	36.0	.03	.08
TMEL-M1420010005	M14	2	10	24.0	105	10	5	42.0	.03	.08
TMEL-M1620012005	M16	2	12	26.0	105	12	5	48.0	.03	.08

TMCEL - Thread Mill.ISO.1.5D Coolant ISO 螺紋銑刀/有效/內冷

ZrN-A nACRo

切削條件表 **P171**
Cutting Condition

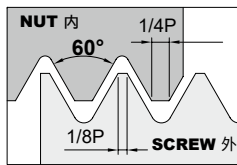

ISO R262 (DIN13) /6H

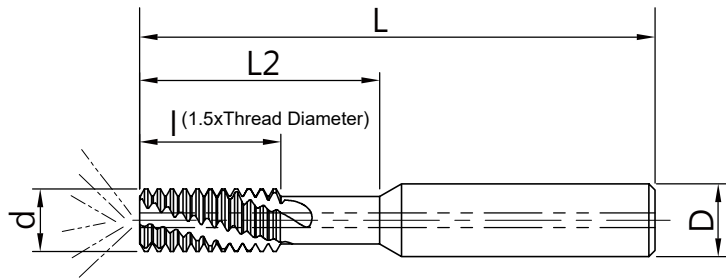

MODE	Thread Diameter	Pitch	Diameter	Thread Length	Full Length	Shank Diameter	No. of flutes	Effective Length	Coating	
型號	M 螺紋	mm 螺距	d 刃徑	l 螺紋長度	L 全長	D 柄徑	z 刃數	L2 有效長度	ZrN-A	nACRo
TMCEL-M0610004503	M6	1	4.5	10.0	65	6	3	18.0	.03	.08
TMCEL-M0812506004	M8	1.25	6	13.8	65	8	4	24.0	.03	.08
TMCEL-M1015007504	M10	1.5	7.5	16.5	80	10	4	30.0	.03	.08
TMCEL-M1217509504	M12	1.75	9.5	19.3	105	12	4	36.0	.03	.08
TMCEL-M1420010004	M14	2	10	24.0	105	14	4	42.0	.03	.08
TMCEL-M1620012005	M16	2	12	26.0	105	16	5	48.0	.03	.08

TMCH - Thread Mill.ISO.1.5D/2D/2.5D Chamfer

ISO 螺紋銑刀/倒角

Zn-A nACRo

切削條件表 **P171**
Cutting Condition

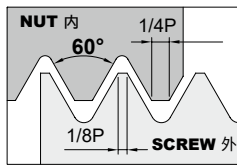

ISO R262 (DIN13) /6H

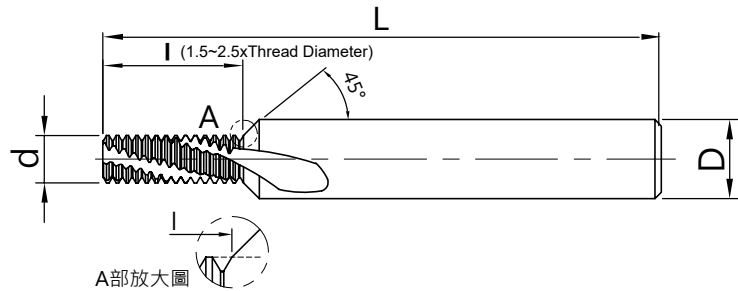

MODE	Thread Diameter	Pitch	Diameter	Thread Length	Full Length	Shank Diameter	No. of flutes	Coating	
型號	M 螺紋	mm 螺距	d 刃徑	螺紋長度	L 全長	D 柄徑	z 刃數	Zn-A	nACRo
TMCH45-M0305002303(TL5.25)	M3 (1.5xD)	0.5	2.3	5.25	65	6	3	.03	.08
TMCH45-M0305002303(TL6.75)	M3 (2xD)	0.5	2.3	6.75	65	6	3	.03	.08
TMCH45-M0407003103(TL7.35)	M4 (1.5xD)	0.7	3.1	7.35	65	6	3	.03	.08
TMCH45-M0407003103(TL8.75)	M4 (2xD)	0.7	3.1	8.75	65	6	3	.03	.08
TMCH45-M0508003803(TL8.4)	M5 (1.5xD)	0.8	3.8	8.40	65	6	3	.03	.08
TMCH45-M0508003803(TL10.8)	M5 (2xD)	0.8	3.8	10.80	65	6	3	.03	.08
TMCH45-M0610004503(TL10.5)	M6 (1.5xD)	1	4.5	10.50	80	8	3	.03	.08
TMCH45-M0610004503(TL13.5)	M6 (2xD)	1	4.5	13.50	80	8	3	.03	.08
TMCH45-M0610004503(TL16.5)	M6 (2.5xD)	1	4.5	16.50	80	8	3	.03	.08
TMCH45-M0812506004(TL14.38)	M8 (1.5xD)	1.25	6	14.38	80	10	4	.03	.08
TMCH45-M0812506004(TL18.13)	M8 (2xD)	1.25	6	18.13	80	10	4	.03	.08
TMCH45-M0812506004(TL21.88)	M8 (2.5xD)	1.25	6	21.88	80	10	4	.03	.08
TMCH45-M1015007504(TL17.25)	M10 (1.5xD)	1.5	7.5	17.25	105	12	4	.03	.08
TMCH45-M1015007504(TL21.75)	M10 (2xD)	1.5	7.5	21.75	105	12	4	.03	.08
TMCH45-M1015007504(TL27.75)	M10 (2.5xD)	1.5	7.5	27.75	105	12	4	.03	.08
TMCH45-M1217509504(TL20.13)	M12 (1.5xD)	1.75	9.5	20.13	105	14	4	.03	.08
TMCH45-M1217509504(TL27.13)	M12 (2xD)	1.75	9.5	27.13	105	14	4	.03	.08
TMCH45-M1217509504(TL32.38)	M12 (2.5xD)	1.75	9.5	32.38	105	14	4	.03	.08

TMCHC - Thread Mill.ISO.1.5D/2D/2.5D Chamfer Coolant ISO 螺紋銑刀/倒角/內冷

ZrN-A nACRo

切削條件表 **P171**
Cutting Condition

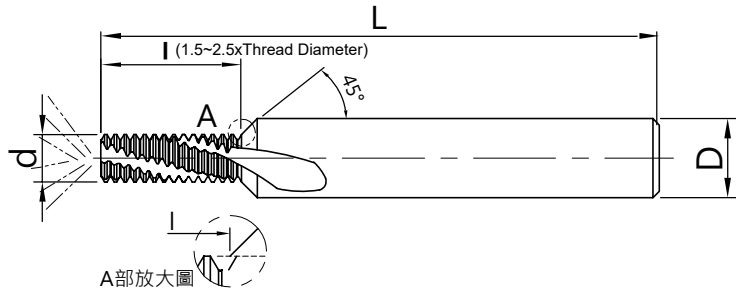
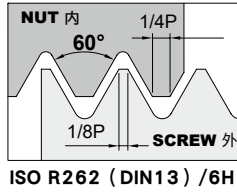

MODE	Thread Diameter	Pitch	Diameter	Thread Length	Full Length	Shank Diameter	No. of flutes	Coating	
型號	M 螺紋	mm 螺距	d 刃徑	l 螺紋長度	L 全長	D 柄徑	z 刃數	ZrN-A	nACRo
TMCHC45-M0508003803(TL8.4)	M5 (1.5xD)	0.8	3.8	8.40	65	6	3	.03	.08
TMCHC45-M0508003803(TL10.8)	M5 (2xD)	0.8	3.8	10.80	65	6	3	.03	.08
TMCHC45-M0610004503(TL10.5)	M6 (1.5xD)	1	4.5	10.50	80	8	3	.03	.08
TMCHC45-M0610004503(TL13.5)	M6 (2xD)	1	4.5	13.50	80	8	3	.03	.08
TMCHC45-M0610004503(TL16.5)	M6 (2.5xD)	1	4.5	16.50	80	8	3	.03	.08
TMCHC45-M0812506004(TL14.38)	M8 (1.5xD)	1.25	6	14.38	80	10	4	.03	.08
TMCHC45-M0812506004(TL18.13)	M8 (2xD)	1.25	6	18.13	80	10	4	.03	.08
TMCHC45-M0812506004(TL21.88)	M8 (2.5xD)	1.25	6	21.88	80	10	4	.03	.08
TMCHC45-M1015007504(TL17.25)	M10 (1.5xD)	1.5	7.5	17.25	105	12	4	.03	.08
TMCHC45-M1015007504(TL21.75)	M10 (2xD)	1.5	7.5	21.75	105	12	4	.03	.08
TMCHC45-M1015007504(TL27.75)	M10 (2.5xD)	1.5	7.5	27.75	105	12	4	.03	.08
TMCHC45-M1217509504(TL20.13)	M12 (1.5xD)	1.75	9.5	20.13	105	14	4	.03	.08
TMCHC45-M1217509504(TL27.13)	M12 (2xD)	1.75	9.5	27.13	105	14	4	.03	.08
TMCHC45-M1217509504(TL32.38)	M12 (2.5xD)	1.75	9.5	32.38	105	14	4	.03	.08

TM3ZT - 3 Pitch Thread Mill.ISO. ISO 3牙式螺紋銑刀

ZrN-A nACRo

切削條件表 **P172**
Cutting Condition

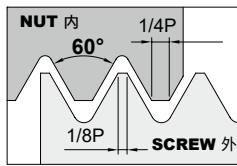

ISO R262 (DIN13) /6H

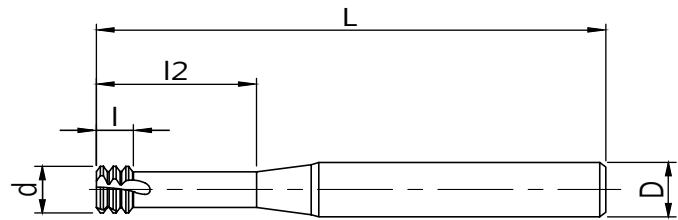

MODE	Thread Diameter	Pitch	Diameter	Thread Length	Full Length	Shank Diameter	No. of flutes	Effective Length	Coating	
型號	M 螺紋	mm 螺距	d 刃徑	l 螺紋長度	L 全長	D 柄徑	z 刃數	L2 有效長度	ZrN-A	nACRo
TM3ZT-M01603501203(EL3.2)	M1.6	0.35	1.2	1.05	50	4	3	3.2	.03	.08
TM3ZT-M01603501203(EL4.8)	M1.6	0.35	1.2	1.05	50	4	3	4.8	.03	.08
TM3ZT-M02004001523(EL4)	M2	0.4	1.52	1.20	50	4	3	4.0	.03	.08
TM3ZT-M02004001523(EL6)	M2	0.4	1.52	1.20	50	4	3	6.0	.03	.08
TM3ZT-M02204501603(EL4.4)	M2.2	0.45	1.6	1.35	50	4	3	4.4	.03	.08
TM3ZT-M02204501603(EL6.6)	M2.2	0.45	1.6	1.35	50	4	3	6.6	.03	.08
TM3ZT-M02504501903(EL5)	M2.5	0.45	1.9	1.35	50	4	3	5.0	.03	.08
TM3ZT-M02504501903(EL7.5)	M2.5	0.45	1.9	1.35	50	4	3	7.5	.03	.08
TM3ZT-M03005002303(EL6)	M3	0.5	2.3	1.50	50	4	3	6.0	.03	.08
TM3ZT-M03005002303(EL9)	M3	0.5	2.3	1.50	50	4	3	9.0	.03	.08
TM3ZT-M04007003103(EL8)	M4	0.7	3.1	2.10	50	4	3	8.0	.03	.08
TM3ZT-M04007003103(EL12)	M4	0.7	3.1	2.10	50	4	3	12.0	.03	.08
TM3ZT-M05008003803(EL10)	M5	0.8	3.8	2.40	50	4	3	10.0	.03	.08
TM3ZT-M05008003803(EL15)	M5	0.8	3.8	2.40	50	4	3	15.0	.03	.08
TM3ZT-M06010004504(EL12)	M6	1	4.5	3.00	50	6	4	12.0	.03	.08
TM3ZT-M06010004504(EL18)	M6	1	4.5	3.00	60	6	4	18.0	.03	.08
TM3ZT-M08012506004(EL16)	M8	1.25	6	3.75	60	6	4	16.0	.03	.08
TM3ZT-M08012506004(EL24)	M8	1.25	6	3.75	60	6	4	24.0	.03	.08
TM3ZT-M10015007504(EL20)	M10	1.5	7.5	4.50	60	8	4	20.0	.03	.08
TM3ZT-M10015007504(EL30)	M10	1.5	7.5	4.50	75	8	4	30.0	.03	.08
TM3ZT-M12017509504(EL24)	M12	1.75	9.5	5.25	75	10	4	24.0	.03	.08
TM3ZT-M12017509504(EL36)	M12	1.75	9.5	5.25	100	10	4	36.0	.03	.08

TMSM1ZT - 1 Pitch Miniature Thread Mill.ISO. ISO 單牙式微小徑螺紋銑刀

ZrN-A nACRo

切削條件表 **P172**
Cutting Condition

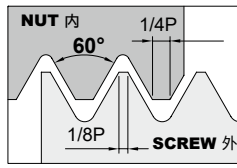

ISO R262 (DIN13) /6H

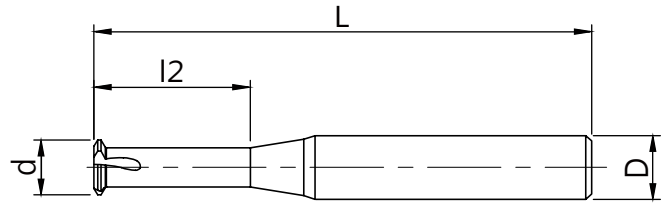

MODE	Thread Diameter	Pitch	Diameter	Full Length	Shank Diameter	No. of flutes	Effective Length	Coating	
型號	M 螺紋	mm 螺距	d 刃徑	L 全長	D 柄徑	z 刃數	L2 有效長度	ZrN-A	nACRo
TMSM1ZT-M01002500723	M1.0	0.25	0.72	50	4	3	3.1	.03	.08
TMSM1ZT-M01202500903	M1.2	0.25	0.9	50	4	3	3.7	.03	.08
TMSM1ZT-M01403001053	M1.4	0.3	1.05	50	4	3	4.3	.03	.08
TMSM1ZT-M01603501203	M1.6	0.35	1.2	50	4	3	5.0	.03	.08
TMSM1ZT-M02004001523	M2	0.4	1.52	50	4	3	6.2	.03	.08
TMSM1ZT-M02204501603	M2.2	0.45	1.6	50	4	3	6.8	.03	.08
TMSM1ZT-M02504501903	M2.5	0.45	1.9	50	4	3	7.8	.03	.08
TMSM1ZT-M03005002303	M3	0.5	2.3	50	4	3	9.3	.03	.08

TMPA - Internal / External Thread Mill 通用款內外牙60度螺紋銑刀

ZrN-A nACRo

切削條件表 **P172**
Cutting Condition

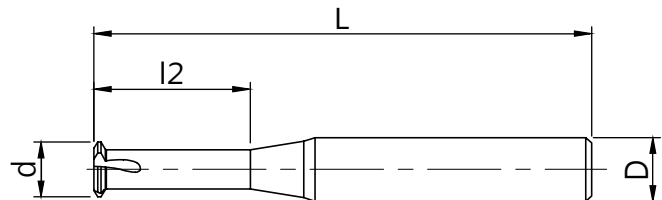
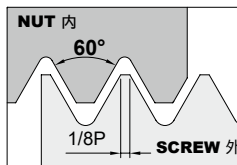

MODE	Pitch		Diameter	Thread Length	Full Length	Shank Diameter	No. of flutes	Effective Length	Coating	
型號	mm	TPI	d 刃徑	l 螺紋長度	L 全長	D 柄徑	z 刃數	L2 有效長度	ZrN-A	nACRo
TMPA60-035-0600195003	0.35-0.6	72-40	1.95	0.75	50	4	3	6.0	.03	.08
TMPA60-050-0770245003	0.5-0.8	48-32	2.45	0.75	50	4	3	7.7	.03	.08
TMPA60-050-1000315003	0.5-0.8	48-32	3.15	0.90	50	4	3	10.0	.03	.08
TMPA60-050-1200400003	0.5-1.0	48-24	4	1.05	50	4	3	12.0	.03	.08
TMPA60-050-1500470004	0.5-1.25	48-20	4.7	1.05	60	6	4	15.0	.03	.08
TMPA60-050-1800600004	0.5-1.25	48-20	6	1.20	60	6	4	18.0	.03	.08
TMPA60-075-2400800004	0.75-1.5	32-16	8	1.20	60	8	4	24.0	.03	.08
TMPA60-100-3001000005	1.0-2.5	24-10	10	1.35	75	10	5	30.0	.03	.08
TMPA60-100-3601200005	1.0-2.5	24-10	12	1.35	100	12	5	36.0	.03	.08

TMCHD - 2 Flutes Drill Thread Mill for Internal Threads
2刃鑽+銑+倒角多工能螺紋銑刀

訂製款
 Customized

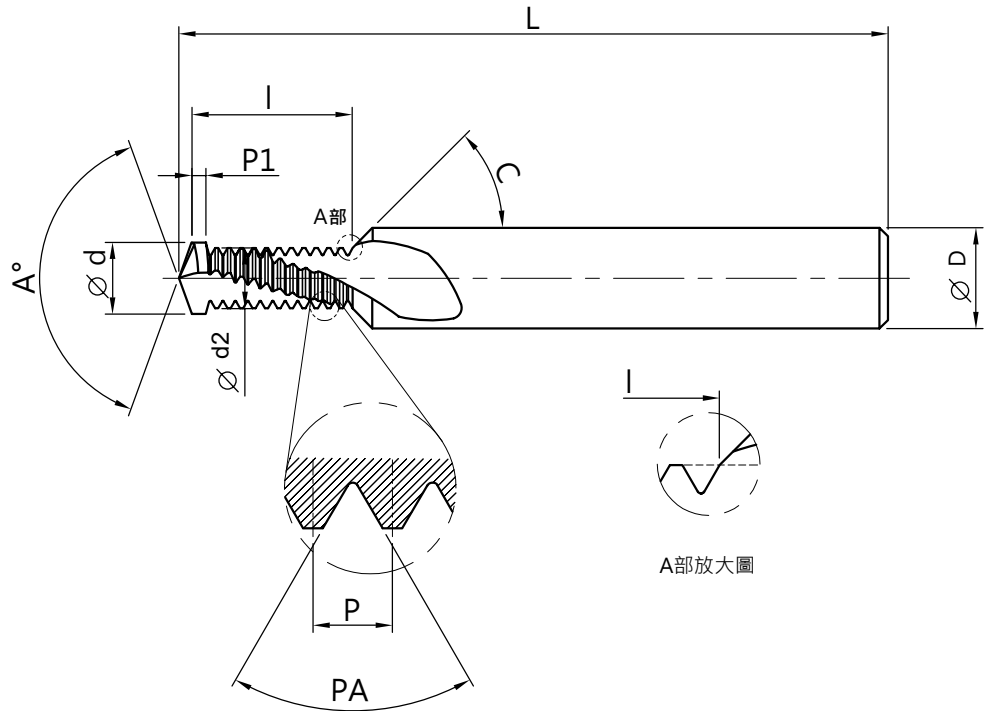

D = _____ C = _____

L = _____ I = _____

P = _____ P1 = _____

d = _____ d2 = _____

A = _____ PA = _____

M = _____
 (螺紋尺寸)

Application 適用材質：

◎ Excellent 適合 ○ Good 佳

Carbon steel, Alloy steel 炭素鋼, 合金鋼	Pre-harden steel 預硬鋼	High-hardened 高硬度鋼				Stainless steel 不鏽鋼	Cast iron 鑄鐵	Copper alloy 銅合金, 銅	Aluminum alloy 鋁合金	Titanium alloy 鈦合金	Nickel/Inconel alloy 鎳基合金
	~45HRC	~50HRC	~55HRC	~60HRC	~65HRC						
							○		◎		

TMFP - High Accuracy Full Profile Thread Mill 高精度全牙式螺紋銑刀

訂製款
Customized

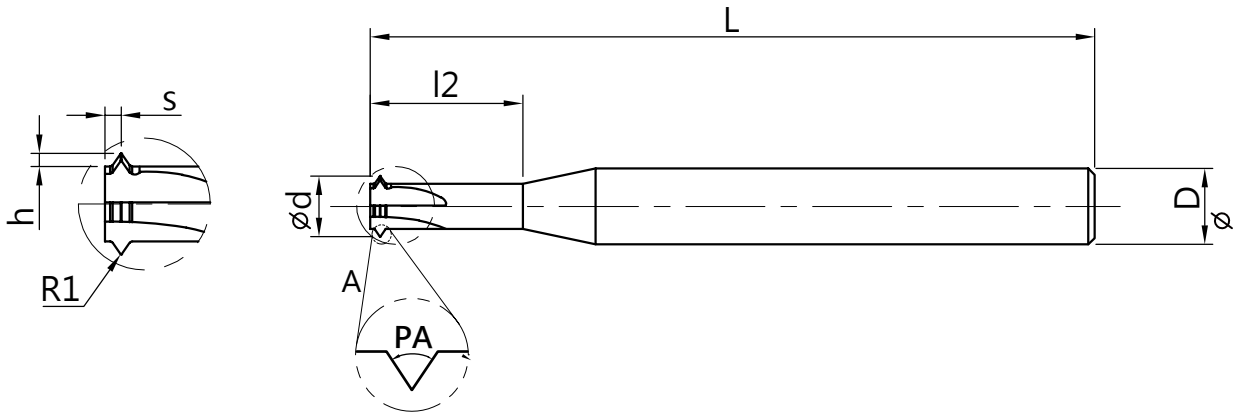

$D =$ _____ $l_2 =$ _____

$L =$ _____ $R1 =$ _____

$S =$ _____ $h =$ _____

$d =$ _____ 刃數 = _____

$PA =$ _____ $M =$ _____
(螺紋尺寸)

無塗層 nACRo ZrN-A nACo

Application 適用材質：

◎ Excellent 適合 ○ Good 佳

Coating 塗層	Carbon steel, Alloy steel 炭素鋼, 合金鋼	Pre-harden steel 預硬鋼	High-hardened 高硬度鋼				Stainless steel 不鏽鋼	Cast iron 鑄鐵	Copper alloy 銅合金, 銅	Aluminum alloy 鋁合金	Titanium alloy 鈦合金	Nickel/Inconel alloy 鎳基合金
		~45HRC	~50HRC	~55HRC	~60HRC	~65HRC						
nACRo	◎	◎	○				○	◎			○	○
ZrN-A	○	○					◎		○	○	○	○
nACo		◎	◎	◎	◎	○						